

NEW

Akyver Panel[®] 50

50 mm Clip-on System

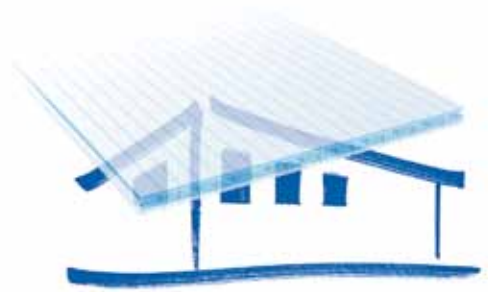

Multi-wall Polycarbonate

Advantages

- Material that meets the requirements and demands of buildings with high energy efficiency
- Excellent thermal insulation (0.83 W/m².°C)
- Rigidity: its 50 mm thickness gives it good load capacity
- Excellent water tightness when clipped into place
- For cladding applications and sheds
- Easy assembling

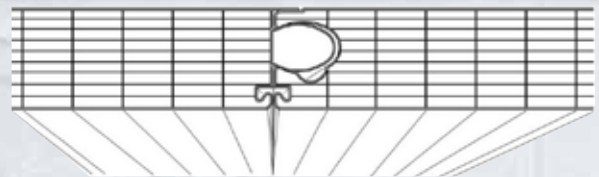
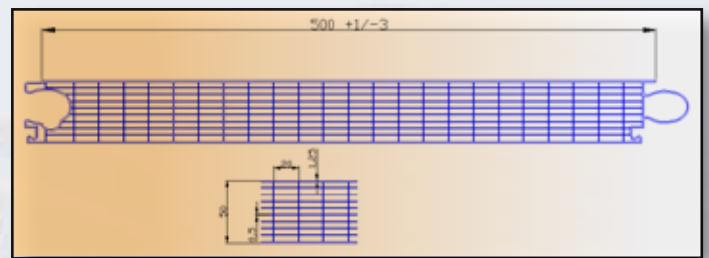

Cladding system in 50 mm thick multi-wall polycarbonate:

- Ideal for all new cladding or renovation work
- Complete range of aluminium sections and thermal break sections. Accessories for fast and professional fitting.

BUILDING SOLUTIONS

www.kaysersberg-plastics.com

KaysersbergPlastics

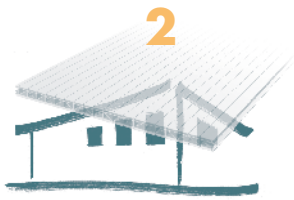

technical characteristics

Akyver Panel® 50

Akyver Panel® 50

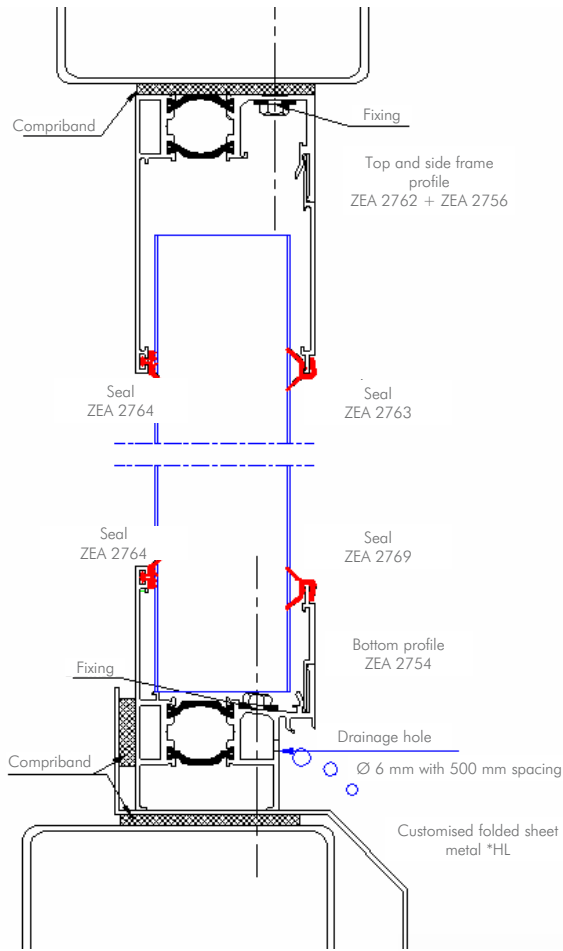

Cladding assembly with aluminium thermal break profiles ZEA 2760 + 2761 and 2762 + 2756

Technical data	Value	Tolerance
Usable width (mm)	500	± 3.0
Thickness (mm)	50	± 1.0
Weight (kg/m ²)	5	
Length (mm)*	6 000 or 7 000	
Colour	Translucent Opal	
Light transmission (%)	50 28	
Fire classification (European norm)	B-S2, d0 (M1)	
UV protection	by coextrusion on the outer surface	
Thermal insulation (W/m ² .°C)	0.83	
Linear expansion coefficient (mm/m/°C)	0.065	
Modulus of elasticity E (N/m ²)	2 300	
Usage temperature (°C)	- 40/ +115	
Ball-shot resistance	18 032 — T3 (according to DIN)	
Resistance 1,200J		
Minimum slope for installation with respect to the vertical	0° to 60°	

* Others on request

10 year guarantee

Akyver Panel® 50

regulations & admissible loads

The following table of loads is based on our experience and applications of this product. Optimum use of the product is subject to strict adherence to the recommendations given in this technical datasheet.

Loads for Akyver Panels® and/or spacing of the intermediate beams

Number of supports	Wind effect (N/m ²)	Load (m)					
		1.25	1.50	1.75	2.00	2.20	2.50
3 supports or more	Pressure	3,480	2,450	1,800	1,250	960	670
	Vacuum ZEA 2756 hook (60 mm)	1,990	1,850	1,250	970	820	670
	Vacuum ZEA 2757 hook (120 mm)	2,270	1,890	1,440	1,140	970	790